

**Ball valve coloro type 354 PVC-U  
With solvent cement sockets metric**

**Model:**

- Lever blue
- Ball seal HD-PE / lubricant compound
- Monobloc structure
- Actuator unit not connectable
- Only bulk pack GP are delivered

d [mm]	DN [mm]	PN	EPDM Code	kg	z [mm]	D [mm]	L [mm]	L1 [mm]	H [mm]
20	15	16	<b>161 354 002</b>	0.099	49	49	81	78	51
25	20	16	<b>161 354 003</b>	0.140	54	54	92	92	58
32	25	16	<b>161 354 004</b>	0.194	60	64	104	92	63
40	32	16	<b>161 354 005</b>	0.343	70	78	122	116	77
50	40	16	<b>161 354 006</b>	0.466	78	90	140	116	83
63	50	16	<b>161 354 007</b>	0.837	93	112	169	140	102

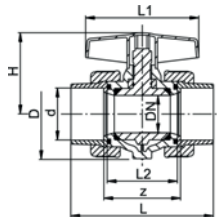

**Ball valve coloro type 355 PVC-U  
With solvent cement sockets BS**

**Model:**

- Lever blue
- Ball seal HD-PE / lubricant compound
- Monobloc structure
- Actuator unit not connectable
- Only bulk pack GP are delivered

Inch	DN [mm]	PN	EPDM Code	kg	z [mm]	D [mm]	L [mm]	L1 [mm]	H [mm]	L2 [mm]
½	15	16	<b>161 355 202</b>	0.128	60	49	92	78	51	54
¾	20	16	<b>161 355 203</b>	0.102	66	54	104	92	58	60
1	25	16	<b>161 355 204</b>	0.240	69	64	113	92	63	63
1 ¼	32	16	<b>161 355 205</b>	0.414	80	78	132	116	77	74
1 ½	40	16	<b>161 355 206</b>	0.584	85	90	147	116	83	79
2	50	16	<b>161 355 207</b>	1.019	97	112	175	140	102	91

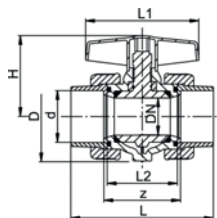

**Ball valve coloro type 355 PVC-U  
With solvent cement sockets metric**

**Model:**

- Lever blue
- Ball seal HD-PE / lubricant compound
- Monobloc structure
- Actuator unit not connectable
- Only bulk pack GP are delivered

d [mm]	DN [mm]	PN	EPDM Code	kg	z [mm]	D [mm]	L [mm]	L1 [mm]	L2 [mm]	H [mm]
20	15	16	<b>161 355 002</b>	0.128	60	49	92	78	54	51
25	20	16	<b>161 355 003</b>	0.182	66	54	104	92	60	58
32	25	16	<b>161 355 004</b>	0.242	69	64	113	92	63	63
40	32	16	<b>161 355 005</b>	0.429	80	78	132	116	74	77
50	40	16	<b>161 355 006</b>	0.576	85	90	147	116	79	83
63	50	16	<b>161 355 007</b>	1.001	97	112	175	140	91	102