



Complete device, top mounting



Powering Business Worldwide™

Part no. M22-I2-M1
Article no. 216529
Catalog No. M22-I2-M1Q

Delivery programme

Product range			RMQ-Titan (drilling dimensions 22.5 mm)
Basic function			Pushbutton actuators
Single unit/Complete unit			Complete unit
Description			without indicator light
Function			momentary
Number of locations		Qty.	2
Function			momentary
Function			Spring-return
Contacts			
N/O = Normally open			2 N/O
N/C = Normally closed			2 NC
Notes			= safety function, by positive opening to IEC/EN 60947-5-1
Contact sequence			
Colour of enclosure top			
RAL Value			RAL 7035
Front ring			Bezel: Silver
Connection to SmartWire-DT			no

Approvals

Product Standards	IEC/EN 60947-5; UL 508; CSA-C22.2 No. 14-05; CSA-C22.2 No. 94-91; CE marking
UL File No.	E29184
UL Category Control No.	NKCR
CSA File No.	012528
CSA Class No.	3211-03
North America Certification	UL listed, CSA certified
Degree of Protection	UL/CSA Type 3R, 4X, 12, 13

General

Standards			IEC/EN 60947 VDE 0660
Lifespan, mechanical	Operations	x 10 ⁶	> 5
Operating frequency	Operations/ h		3600
Actuating force		n	5
Protection type			IP67, IP69K
Climatic proofing			Damp heat, constant, to IEC 60068-2-78 Damp heat, cyclic, to IEC 60068-2-30
Ambient temperature		°C	
Open		°C	- 25 - + 70
Mounting position			As required

Mechanical shock resistance		g	30 Shock duration 11 ms Sinusoidal according to IEC 60068-2-27
Cable entry knockouts			
Base		Quantity x M...	2 x 20
Sides		Quantity x M...	1 x 20 2 x 25/20

Technical data ETIM 5.0

Low-voltage industrial components (EG000017) / Enclosure for control circuit devices (EC000200)
 Electric engineering, automation, process control engineering / Low-voltage switch technology / Command and alarm device / Housing for command and alarm devices
 (ecl@ss8-27-37-12-05 [AKF023010])

Number of command positions			2
Construction type housing			Surface mounting housing
Material housing			Plastic
Diameter openings		mm	22
Colour housing cover			Grey
Degree of protection (IP)			IP67
Width		mm	120
Height		mm	70
Depth		mm	80

Dimensions

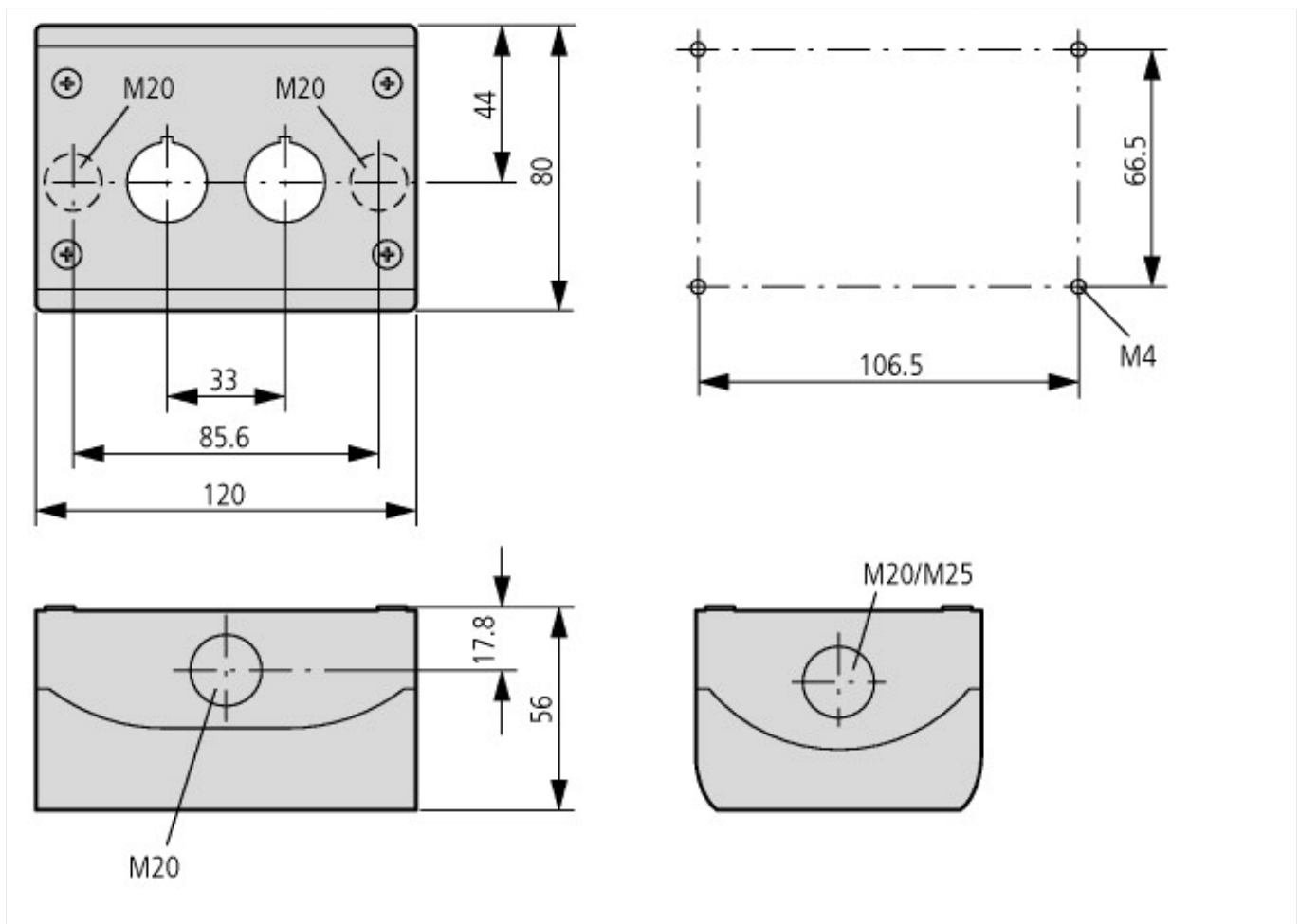

Additional product information (links)

IL04716002Z (AWA1160-1745) RMQ-Titan System	
IL04716002Z (AWA1160-1745) RMQ-Titan System	ftp://ftp.moeller.net/DOCUMENTATION/AWA_INSTRUCTIONS/IL04716002Z2013_08.pdf