

Datasheet

9.7mm Lever Press Punch & Die Combinations

RS Stock number 607-718



Specification:

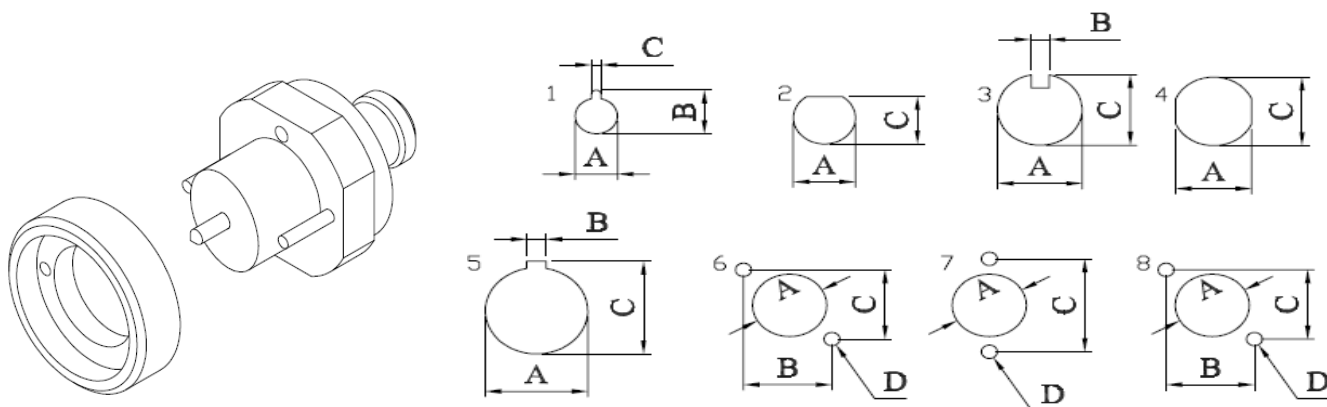

	Type	Size (mm)			
		A	B	C	
1	3&4mm Panel mounting Sockets	8.1	2.4	9.57	
2	BNC Round Socket	9.7		8.8	
	20mm Fuse Holder/UHF round socket	12.2		12	
3	Toggle Switch 12	12	1.3	11.3	
4	Strain Relief Brush	11.8		12.7	
	Strain Relief Brush	14		15.9	
5	Din Circular Socket	16	3	17.2	
	Mains Push Button Switch and BNC Socket insulator	12	2.7	13	
		A	B	C	D
6	7000 Series Panel Socket XLR 31	25	16.65	26.16	3.2
7	7000 Series Panel Plug XLR 32	20		26.97	3.2
8	7000 Series Universal Panel Punch	24	19	24	3.5