

FILE NO:

DESCRIPTION CONTROL

REV	DESC	DATE	APP
R1	R1	2012/4/23	

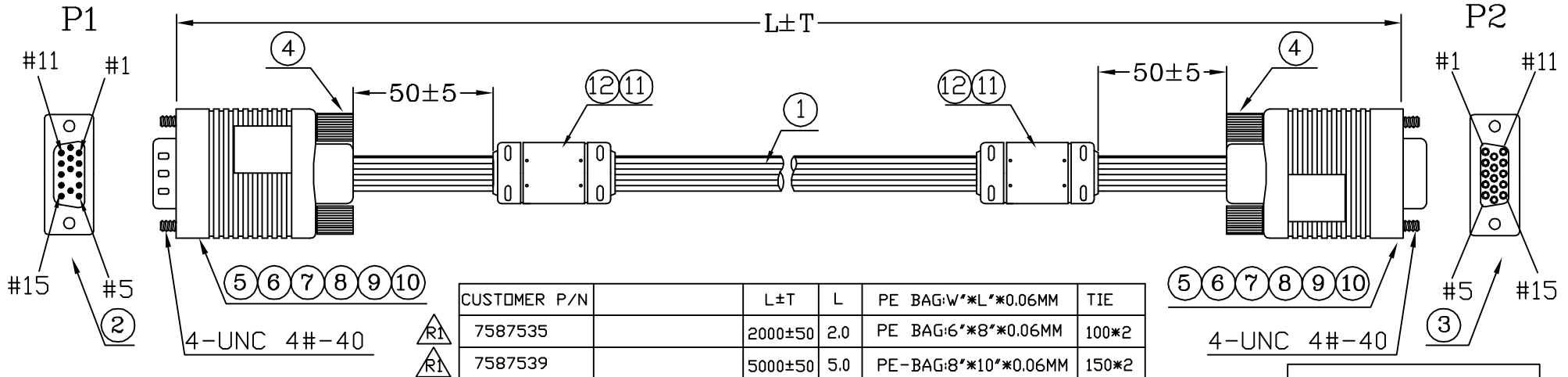

CUSTOMER P/N	L±T	L	PE BAG:W*L*0.06MM	TIE
7587535	2000±50	2.0	PE BAG:6*8*0.06MM	100*2
7587539	5000±50	5.0	PE-BAG:8*10*0.06MM	150*2

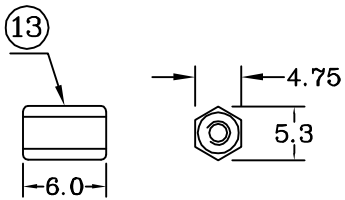

* LABEL:758753X*45*25MM	1	PCS		
* 3000300001x TIE-A-BLACK	L*2	MM		
* 310000000012 CARTON:46*30*25CM	A/R	PCS		
* 300010000001 PE BAG:30*28*0.08MM	A/R	PCS		
* 300030000XX PE BAG:W*L*0.06MM	1	PCS		
13 NUTS:4.75*6.0MM(六角)(4#-40)	2	PCS		
12 230010000024 CORE:17.5*28.5*9.5MM	2	PCS		
11 120010000031 PVC-BLACK10/50P	66.5	G		
10 210030000062 HI TEAMP TAPE:w:24MM;	70*2	MM		
9 210010000347 FOIL-CU-31MM	55*2	MM		
8 120020000001 PE-5321	9.0	G		
7 200032000158 TUBE-HT-ø3.0MM	8*6	MM		
6 200032000157 TUBE-HT-ø2.0MM	6*6	MM		
5 200032000155 TUBE-HT-ø1.0MM	12*6	MM		
4 240010200050 SRW-Q39.6/BK10	4	PCS		
3 104-1520120010-C CDS-H15S<BK>	1	PCS		
2 104-1510120010X-C CDS-H15P/-9<BK>	1	PCS		
1 130611110004X 28**3COAX+28*8C+ADB BK10-8.0U2919	L	M		
NO	PART NO.	DESCRIPTION	QTY	UNIT

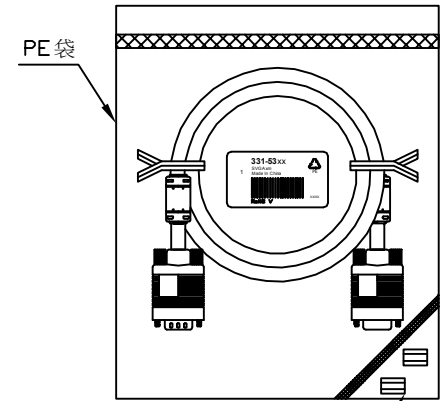

PIN ASSIGNMENT

P1		P2
1	COAX-RED-IN	1
6	COAX-RED-GND	6
2	COAX-GREEN-IN	2
7	COAX-GREEN-GND	7
3	COAX-BLUE-IN	3
8	COAX-BLUE-GND	8
4		4
5		5
10		10
11		11
12		12
13		13
14		14
15		15
S		S

INNER MOLDING	AHD1514		
OUTER MOLDING	AHD1539	HT005	
		ITEM: 7587535&7587539	REV R1
DRAW, BY: 陳銳斌		SCALE: NONE	DATE: 2012.01.30
CHECK, BY:		CUSTOMER: C331	PAGE: 1/1
APP, BY:		CUSTOMER P/N: 758753X	R1
ALL DIMENSIONS IN mm			



RoHS COMPLIANT