



EN

## Datasheet

# RS PRO BATTERY MODULAR CONNECTORS

## 50/ 75 AMP CONTACTS

Stock number: 178-7197

### MAXIMUM ELECTRIC CURRENT:

A.W.G.	8
AMP.	70

CONTACT MATERIAL: COPPER

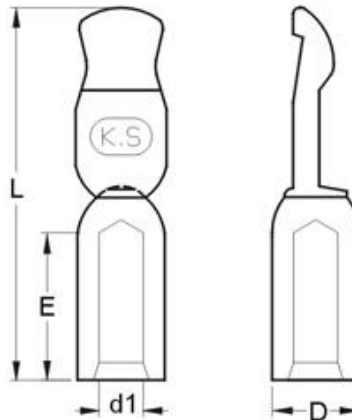

WIRE RANGE A.W.G. mm <sup>2</sup>	DESCRIPTION	DIMENSION inch(mm)			
		L	E	d1	D
8 A.W.G.	<b>(1)INDIVIDUAL CONTACT</b> CAN BE USED WITH ONE 75 AMP SERIES HOUSINGS	1.169	0.472	0.189	0.280
8 mm <sup>2</sup>	<b>(2)CONTACT SET:</b> TWO CONTACTS WITH ONE 50 AMP SERIES HOUSING	29.7	12.0	4.8	.7.1